

Hipy 110 round / square asy LED

123452XX-B1_123453XX-B1_123462XX-B1_123463XX-B1

- 1
- A) Without conbox Ø100 H105
B) With conbox round Ø100 H165
C) With conbox square Ø100 H150

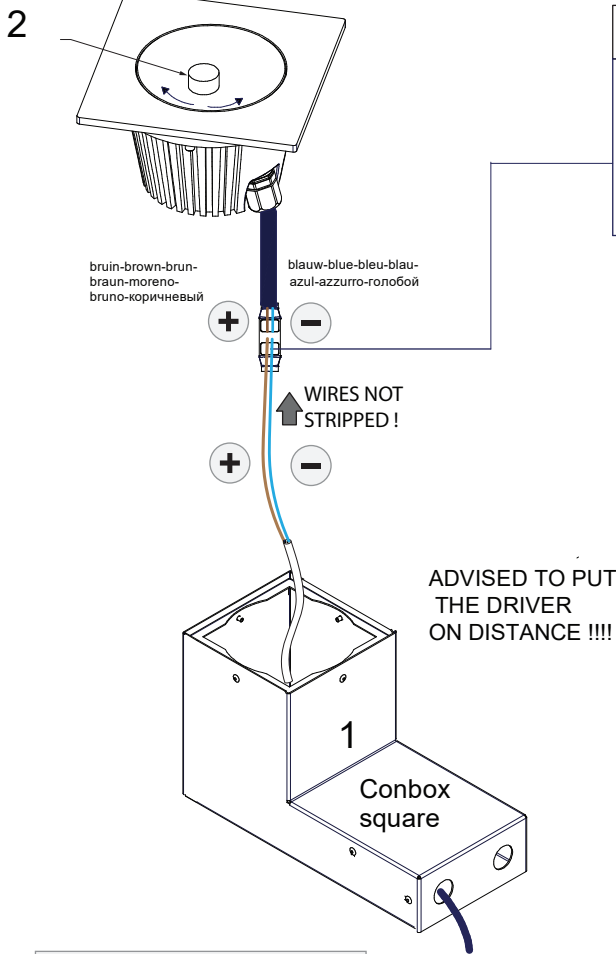
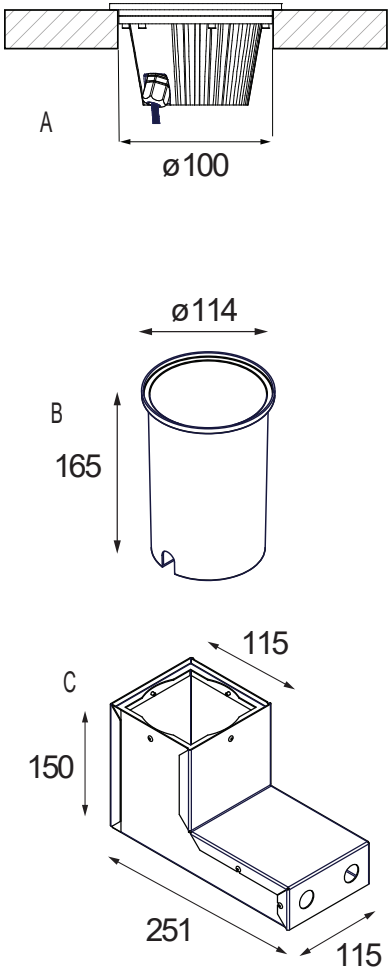

ELECTRICAL SPECS LED-FITTURE			
Drive Current (mA)	Forward Voltage		Power (W)
	min (Vf)	max (Vf)	
350	13,2	15,0	5,0
500	13,7	15,4	7,2
700	14,2	16,0	10,6
+	RED	-	BLACK
For serial connection, respect polarity! Not suited for connection to mains voltage. Combine with a Modular LED-driver.			

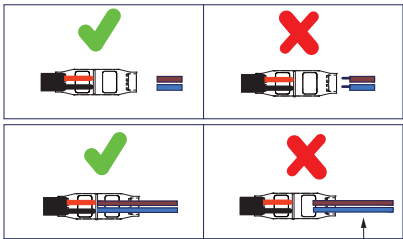
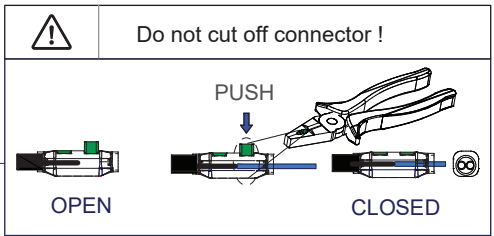

Wires max:1.5mm²
Wire entry diameter:3.0mm

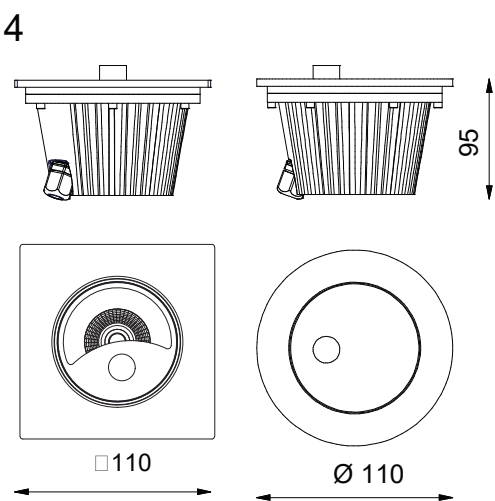
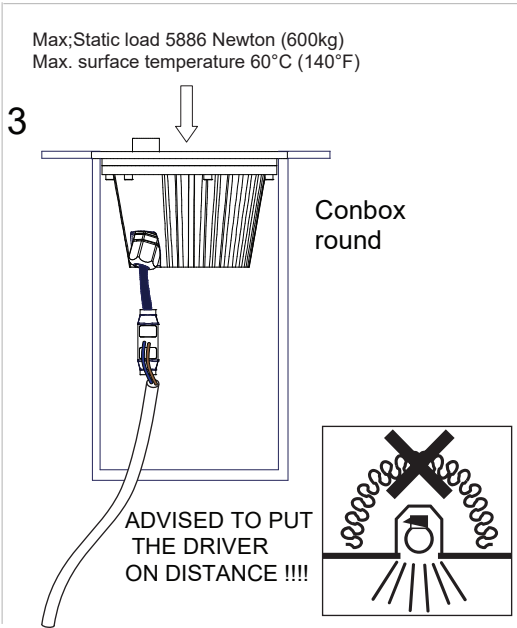

NOT SUITABLE FOR INSTALLATION
≤5KM FROM THE COAST

