

Hipy 110 round / square LED GE

123450XX-B1_123451XX-B1_123454XX-B1_123455XX-B1_123460XX-B1_123461XX-B1_123464XX-B1_123465XX-B1

1

- A) Without conbox Ø100 H105
B) With conbox round Ø100 H165
C) With conbox square Ø100 H150

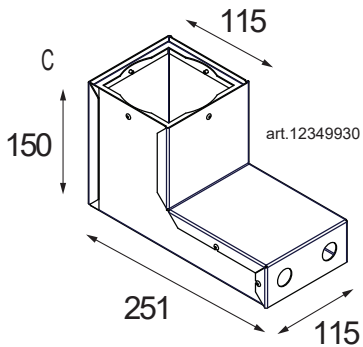
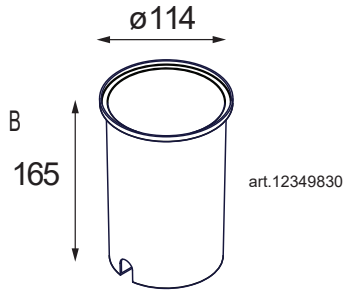
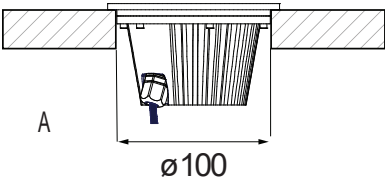

2

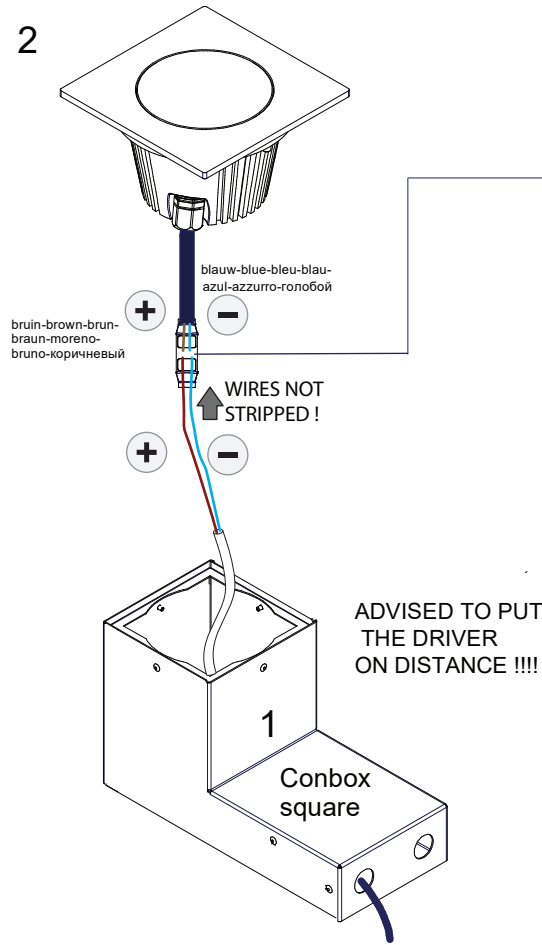

ELECTRICAL SPECS LED-FIXTURE			
Drive Current (mA)	Forward Voltage		Power (W)
	min (Vf)	max (Vf)	
350	13,2	15,0	5,0
500	13,7	15,4	7,2
700	14,2	16,0	10,6
RED		BLACK	
For serial connection, respect polarity! Not suited for connection to mains voltage. Combine with a Modular LED-driver.			

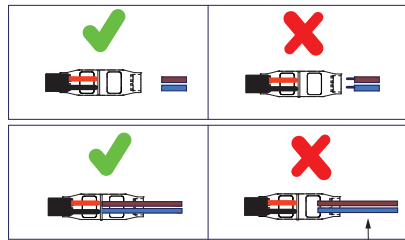
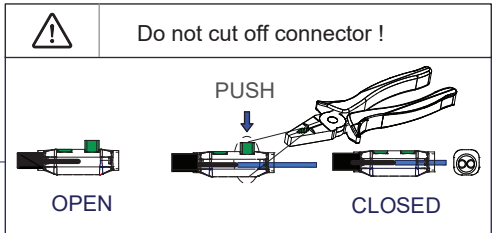

3

Max; Static load 5886 Newton (600kg)
Max. surface temperature 60°C (140°F)

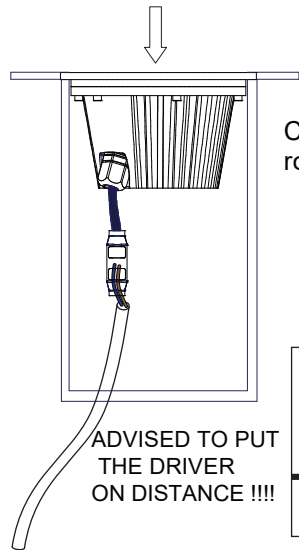

Conbox round

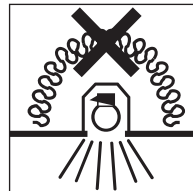

4

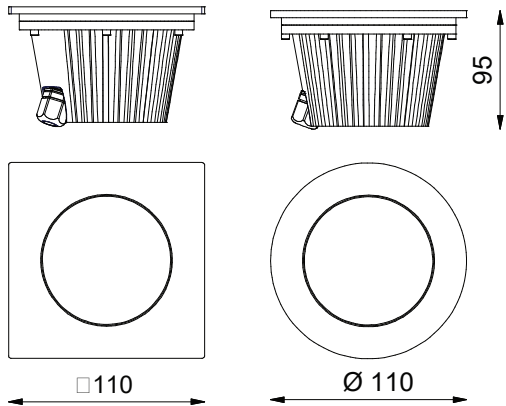

NOT SUITABLE FOR INSTALLATION
≤5KM FROM THE COAST

