

Duell wall IP LED

110750XX\_110751XX

1

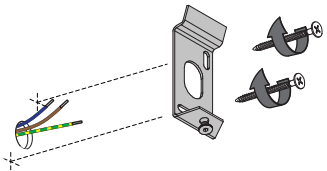

220-230V  
50-60Hz  
N PE L

SCREWS NOT INCLUDED

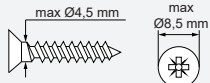

2

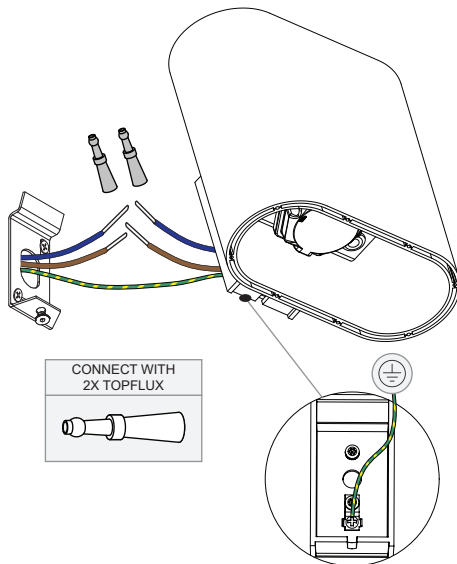

A

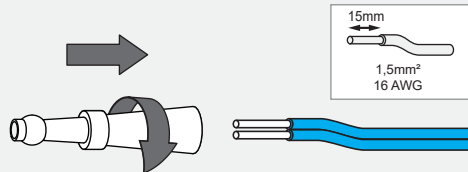

B

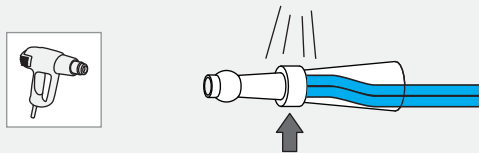

C

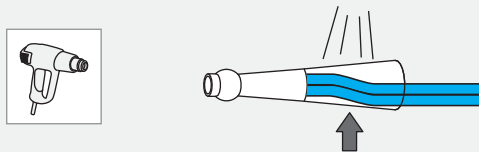

D

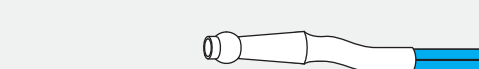

3

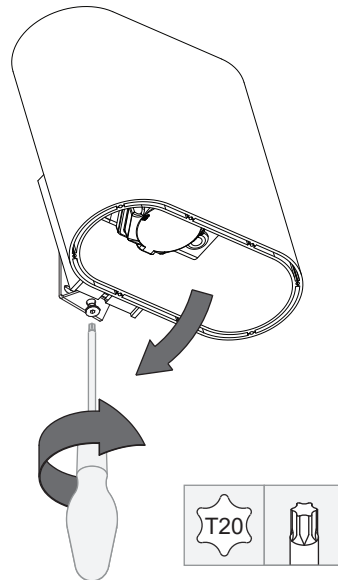

4

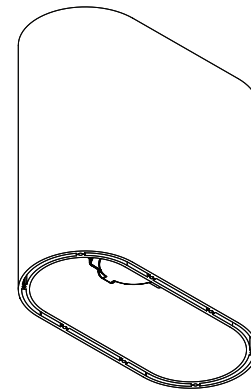

INSTALLATION REMARK - PROJECTED LIGHT

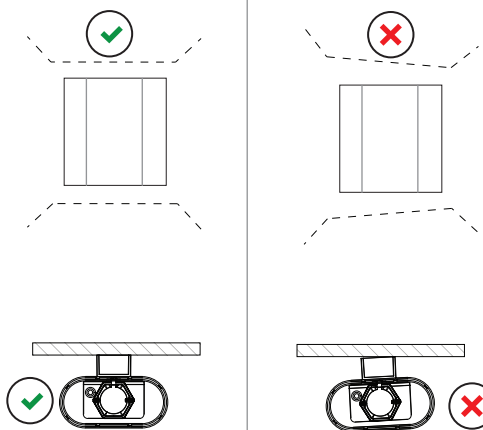

NOT SUITABLE FOR INSTALLATION  
≤5KM FROM THE COAST

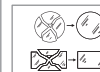

Replace protective shield when broken. The luminaire shall only be used complete with its protective shield.  
Reference number: 1015346 (2.7K) or 1015345 (3K) LED and 4x 1000385 cable conn waterpr.

CLEANING INSTRUCTIONS



To avoid corrosion, clean at least quarterly with a non-abrasive cloth and a neutral detergent. Parts of the fixture which are not protected by the installation housing may not come into contact with the ground or aggressive chemical material (e.g. fertilizers, weed killers, lime,...). Excessive use of de-icing agent in the vicinity of the fixture must be avoided.