

Marbulito jack LED GE

134230XX_134231XX

1 COMPONENTS



"MODUPOINT LED" CONNECTION POINT
NOT INCLUDED

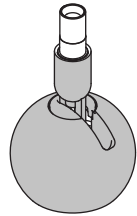

Drive Current (mA)	Forward Voltage		Power (W)
	min (Vf)	max (Vf)	
350	7,5	9,5	3,0
500	7,5	9,5	4,3

For serial connection, respect polarity!

⊕ RED	⊖ BLACK
-------	---------

2 PLUG IN "MODUPOINT LED"

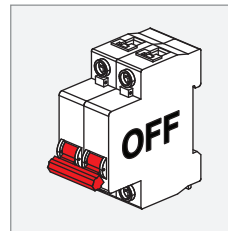
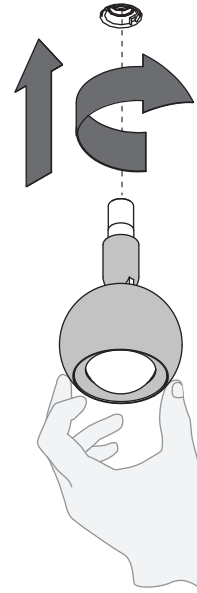

3 POWER INSTALLATION

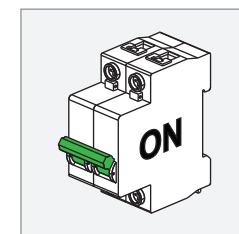

Replace protective shield when broken. The luminaire shall only be used complete with its protective shield.
Reference number: 1014379

DRIVERS & ACCESSORIES

For latest version of driver matrix and available accessories check www.supermodular.com or connect with your sales contact.