

Smart tubed suspended 115 LED for Kompas GE

131416XX



Fixture needs to be combined with “Kompas”
Several DIM options & power options available.
For more info & max amount of fixtures check installation instruction of Kompas.

1

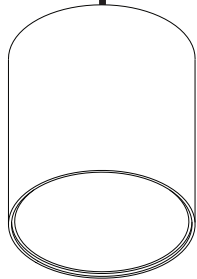
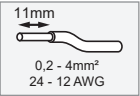

2

Open 'SMART TUBED' cover

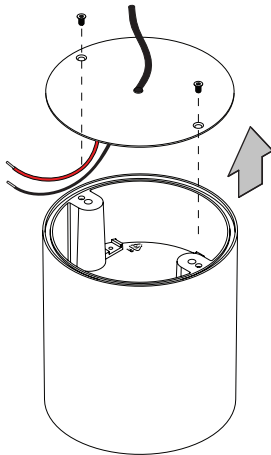

Disconnect fixture connectors
and pull wires through opening

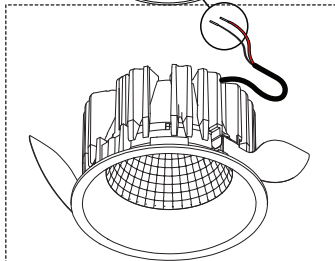
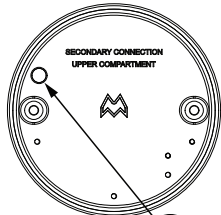

VISUALIZATION WITH 'SMART LOTIS'
'SMART 115 GE' FIXTURE NOT INCLUDED

3

Connect fixture and close
tube cover (re-use included
toothed washers & screws)

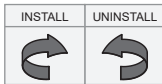
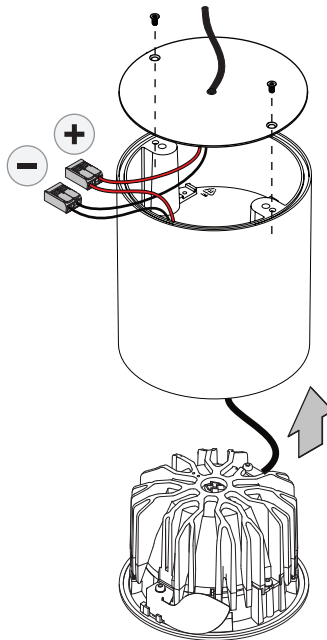

4

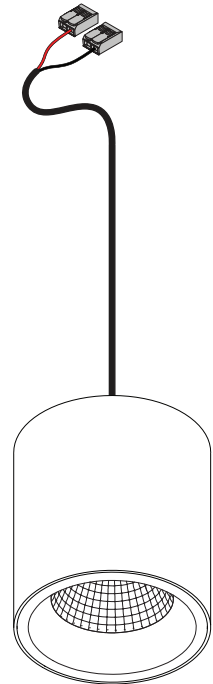

LIGHT SOURCE - DO NOT TOUCH LED

Touching the LED can result in permanent damage of the light source. The light source contained in this luminaire shall only be replaced by the manufacturer or his service agent or a similar qualified person.



PREVENTING ELECTROSTATIC DAMAGE

A discharge of static electricity may damage sensitive components. Therefore do not touch the LED nor the stripped parts of the wires with bare hands. Always be properly insulated by using ESD gloves.