

Minude Jack Suspended 45 1x LED Medium DE

114640XX_114641XX

1 SHORTEN CABLE TO DESIRED LENGTH

"MODUPOINT LED" CONNECTION POINT
NOT INCLUDED

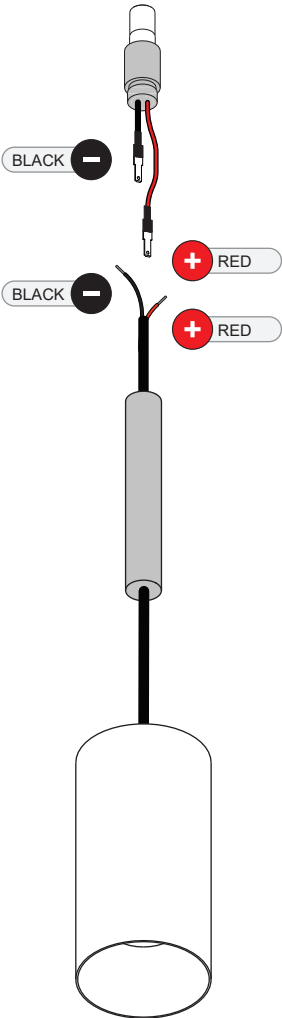

A

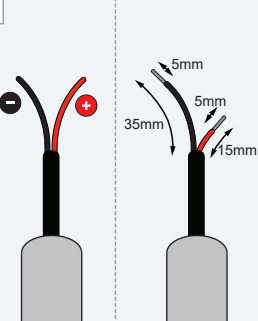

B

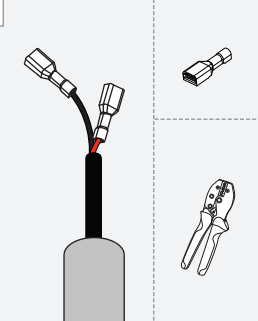

C

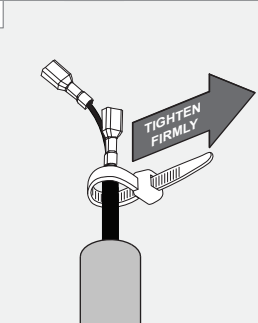

D

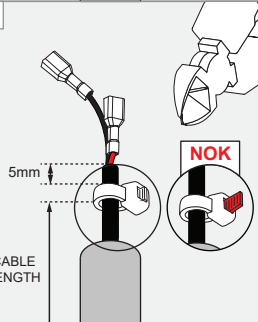

E

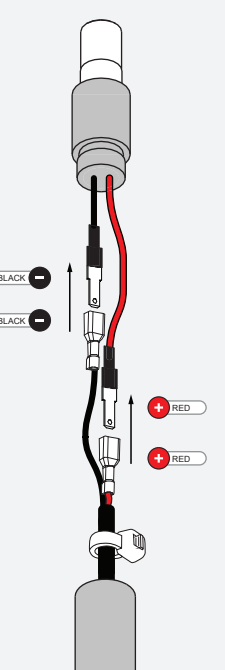

F

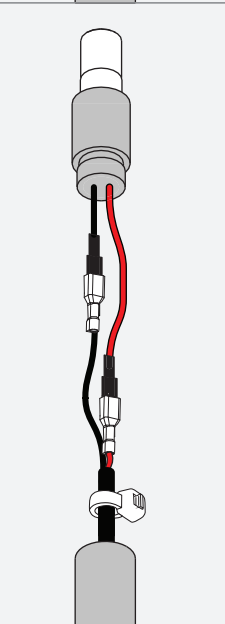

2 SCREW AND CLOSE FIXTURE

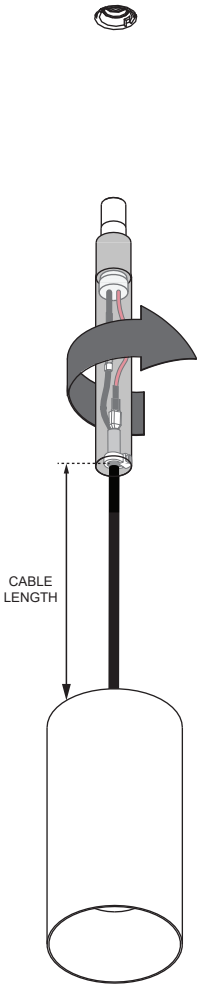

Drive Current (mA)	Forward Voltage		Power (W)
	min (Vf)	max (Vf)	
350	14,8	18,0	5,7
500	15,2	18,6	8,5
For serial connection, respect polarity!			
⊕ RED		⊖ BLACK	

3 PLUG IN "MODUPOINT LED"

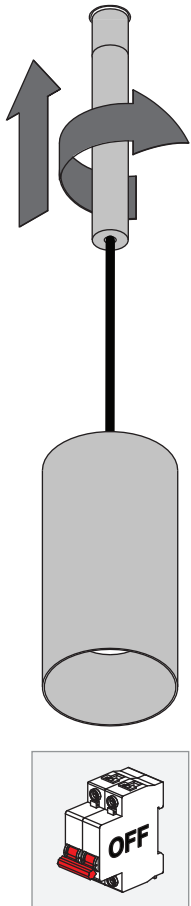

LIGHT SOURCE - DO NOT TOUCH LED
Touching the LED can result in permanent damage of the light source. The light source and/or driver contained in this luminaire shall only be replaced by the manufacturer or his service agent or a similar qualified person.



PREVENTING ELECTROSTATIC DAMAGE
A discharge of static electricity may damage sensitive components. Therefore do not touch the LED nor the stripped parts of the wires with bare hands. Always be properly insulated by using ESD gloves.

4 POWER INSTALLATION

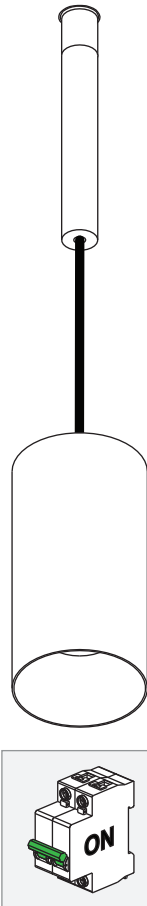

Replace protective shield when broken. The luminaire shall only be used complete with its protective shield.
Reference number: 1014378

DRIVERS & ACCESSORIES

For latest version of driver matrix and available accessories check www.supermodular.com or connect with your sales contact.