

120240XX\_B1

1

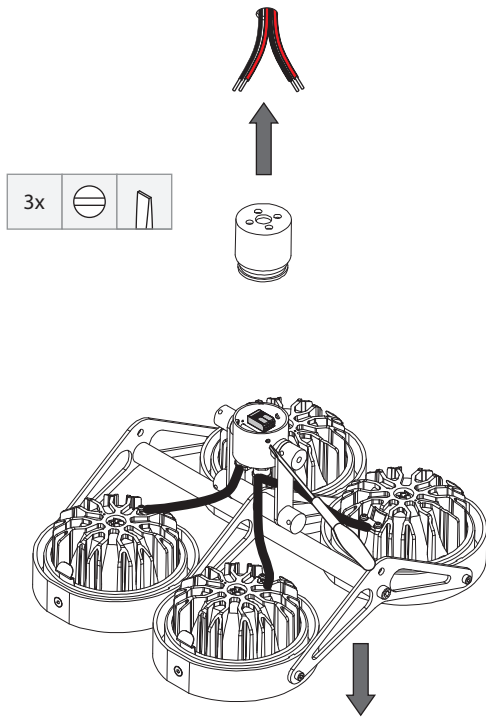

### ELECTRICAL SPECS LED-FIXTURE

Drive Current (mA)	Forward Voltage		Power (W)
	min (Vf)	max (Vf)	
350	56,6	65,8	21,4
500	58	67,2	31,4
700	59,4	69	45

**+** RED      **-** BLACK

For serial connection, respect polarity!  
Not suited for connection to mains voltage.  
Combine with a Modular LED-driver.

2

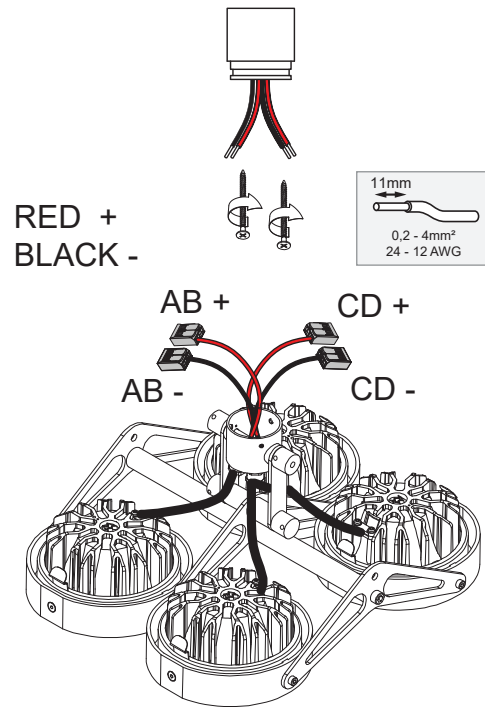

3

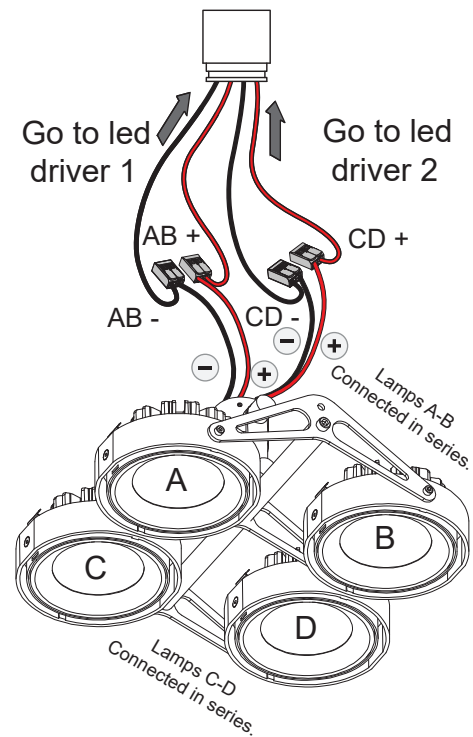

1

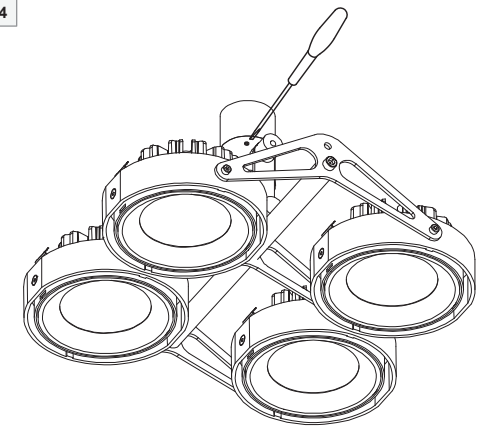

Replace protective shield when broken. The luminaire shall only be used complete with its protective shield.  
Reference number: 1009392



Touching the LED can result in permanent damage of the light source. The light source contained in this luminaire shall only be replaced by the manufacturer or his service agent or a similar qualified person.



A discharge of static electricity may damage sensitive components. Therefore do not touch the LED nor the stripped parts of the wires with bare hands. Always be properly insulated by using ESD gloves.

For latest version of driver matrix and available accessories check [www.supermodular.com](http://www.supermodular.com) or connect with your sales contact.

01 - 15/06/2022

NOT FOR 12V TRANSFORMER



IP 20

UK  
CA