

DALI TUNABLE WHITE PRESET TOUCH PANEL

13590000

1 SPECIFICATIONS AND CHARACTERISTICS

General info	
Type	DALI-2 Touchpanel
Function	Control module
GTIN	9010342013089
dimensions (L x W x H)	87,7mm x 87,7mm x 16,5mm
Material	Touch interface: Glass Frame: Plastic RAL9016
Expected life time	100.000h
Protection degree housing	IP40
Protection degree terminals	IP20
DALI info	
Output type	DALI, DALI-2
Terminal markings	DA, DA
Voltage range	9,5V...-...22,5V (according to IEC62386)
Typ. Current consumption DALI	2mA
Operation mode	Application Controller
Multimaster capable	yes
Environmental info	
Operational ambient temperature	-20°C ... +45°C
Relative humidity, non condensing	15%...-...90%
Terminal info	
Connection type	Spring terminal connectors
Wire size (solid & stranded)	0,5mm ² ...-...1,5mm ² (AWG20...-...AWG16)
Wire size (end ferrule)	0,25mm ² ...-...1mm ²
Stripping length	8.5mm...-...9,5mm
Wire fixation/release	Push mechanism
Standards	
DALI	IEC62386-101:2014 IEC62386-103:2014
EMV	EN 61547 EN 50015 / IEC CISPR15
Safety	EN 61347-2-11 EN 61347-1
Markings	DALI-2 CE

2 DIMENSIONS

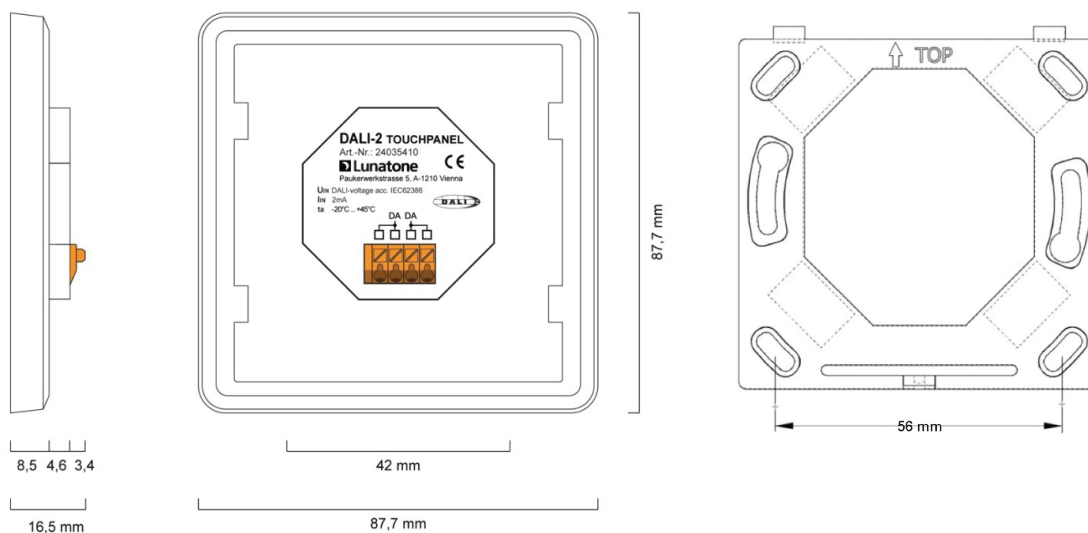

DALI TUNABLE WHITE PRESET TOUCH PANEL

13590000

3 WIRING

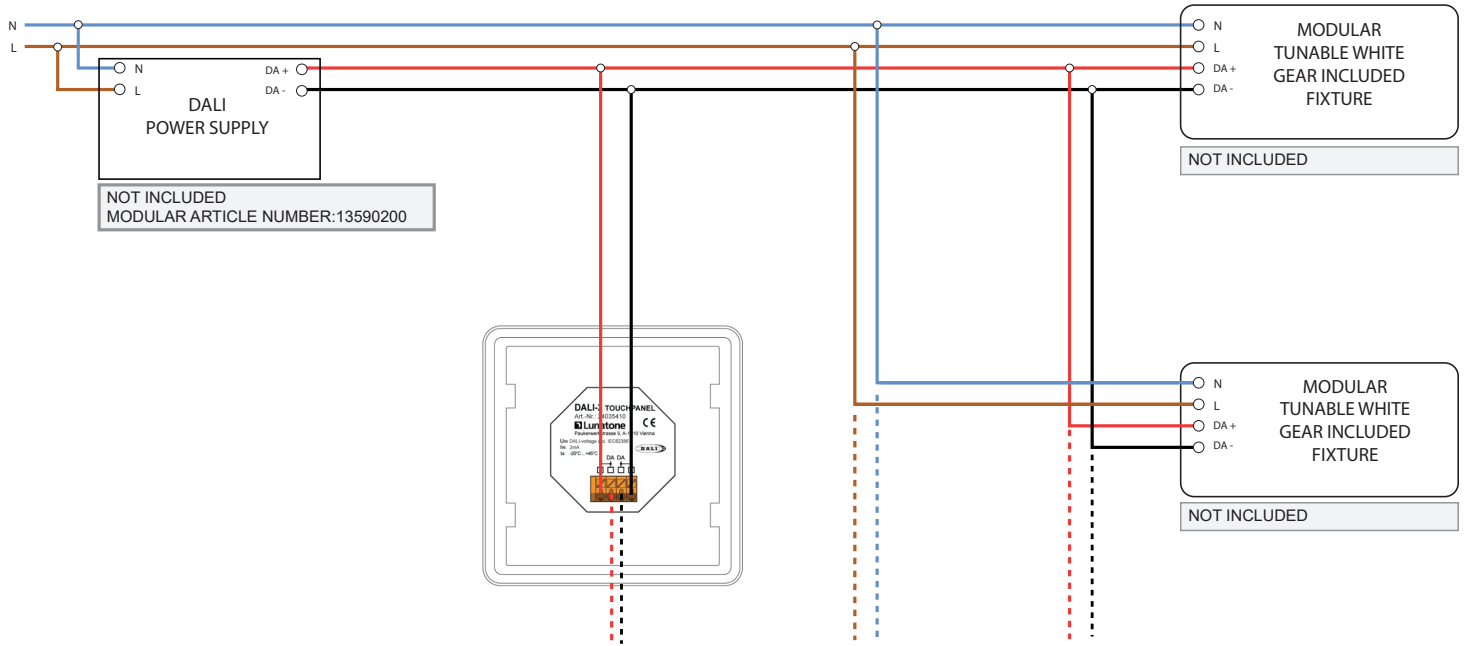

MAXIMUM AMOUNT OF DALI DEVICES DEPENDS ON DALI POWER SUPPLY
WHEN ARTICLE 13590200 IS USED: MAX 20 DEVICES or MAX 20m PROFILE



- TOUCH PANEL IS PROGRAMMED TO BE FULLY FUNCTIONAL
WITH MODULAR TUNABLE WHITE PROFILES & FIXTURES
WITHOUT ADDITIONAL PROGRAMMING
- BROADCAST COMMANDS: ALL DALI GEARS WILL REACT IN THE
SAME WAY
- ONLY TO BE USED IN STANDALONE DALI SYSTEM: NO OTHER
CONTROL DEVICE IN THE NETWORK

4 WALL MOUNTING

4.1 PLATE FIXATION

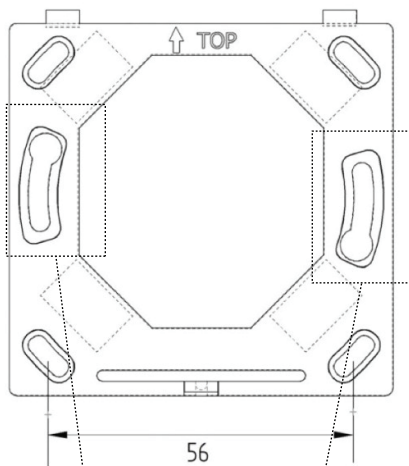

CAN BE USED WITH ELECTRICAL
INSTALLATION BOX

SCREWS ARE
NOT INCLUDED

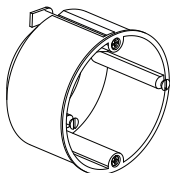

4.2 HOOK-ON PANEL FROM TOP & FIXATE WITH BOTTOM SCREW

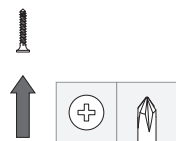
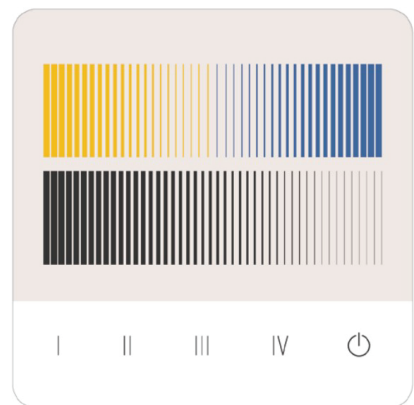

SCREW INCLUDED

DALI TUNABLE WHITE PRESET TOUCH PANEL

13590000

5 FUNCTIONALITY

